

Hand slide valves VBOH

FESTO



Hand slide valves VBOH

Product range overview and type codes

Product range overview

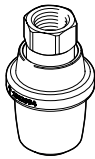
Version	Valve function	Version	Type	Pneumatic connection 1	Pneumatic connection 2	qnN [l/min]	→ Page/ Internet
Hand slide valves	3/2-way, bistable		VBOH	M5, G1/8, G1/4, G3/8, G1/2, G3/4	M5, G1/8, G1/4, G3/8, G1/2, G3/4	236 ... 7691	3

Type codes

001	Series
VBOH	Hand slide valve



002	Valve function
32	3/2-way valve

003	Pneumatic connection 1
M5	M5
G18	G1/8
G14	G1/4
G38	G3/8
G12	G1/2
G34	G3/4

Data sheet

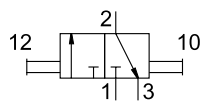
Function



-  - Standard nominal flow rate
236 ... 7691 l/min
-  - Temperature range
-10 ... +80 °C
-  - Operating pressure
-0.95 ... +12 bar



Hand slide valves VBOH are used as a shut-off function for pressurising and exhausting compressed air systems, for example upstream of service unit

combinations, for air guns and also for exhausting pneumatic cylinders.

- Non-overlapping, so no pressure losses when switching
- Minimal installation effort
- High flow rate and operating pressure
- Exclusive design

-  - **Note**

Only use fittings with a cylindrical thread.
Inappropriate mounting of fittings with a conical thread may damage the housing and thereby cause the sleeve to get jammed or to malfunction.

General technical data

Pneumatic connection 1	M5	G1/8	G1/4	G3/8	G1/2	G3/4
Pneumatic connection 2	M5	G1/8	G1/4	G3/8	G1/2	G3/4
Grid dimension [mm]	17	24	31	39.5	45	57.5
Nominal width [mm]	3.6	5.7	8.4	9.9	12.1	19.3
Design	Sleeve valve					
Valve function	3/2-way, bistable					
Actuation type	Manual					
Actuating force [N]	14	17	45	41	37	70
Type of mounting	Screw-in In-line installation					
Mounting position	Any					
Sealing principle	Soft					
Type of control	Direct					

Characteristic flow rate values

Pneumatic connection 1	M5	G1/8	G1/4	G3/8	G1/2	G3/4
Standard nominal flow rate q_{N1} [l/min]	236	777	1675	2201	3420	7691

1) Measured at $p_1 = 6$ bar and $p_2 = 5$ bar, $\Delta p = 1$ bar

Operating and environmental conditions

Operating pressure [bar]	-0.95 ... +12
Operating medium	Compressed air to ISO 8573-1:2010 [7:4:4]
Note on the operating/pilot medium	Lubricated operation possible (in which case lubricated operation will always be required)
Ambient temperature [°C]	-10 ... +80
Temperature of medium [°C]	-10 ... +80
Corrosion resistance CRC ¹⁾	2

1) Corrosion resistance class CRC 2 to Festo standard FN 940070

Moderate corrosion stress. Indoor applications in which condensation can occur. External visible parts with primarily decorative surface requirements which are in direct contact with a normal industrial environment.

Data sheet

Materials

Sectional view

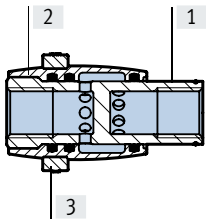

Hand slide valve		
[1]	Screwed trunnion	Anodised wrought aluminium alloy
[2]	Housing	Anodised wrought aluminium alloy
[3]	Grip ring	PBT
-	Seals	NBR
Note on materials		RoHS-compliant

Dimensions

Download CAD data → www.festo.com

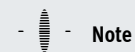
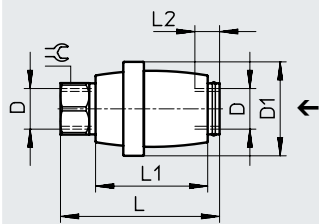

Note

Grip ring is marked with an arrow to indicate the flow direction.

← Flow direction

Type	Connection D	D1 ø	L	L1	L2	⌀
VBOH-32-M5	M5	17	35.6	24.5	5	8
VBOH-32-G18	G1/8	24	38.5	27	9	13
VBOH-32-G14	G1/4	31	52.5	37	13	17
VBOH-32-G38	G3/8	39.5	60.5	42	13.5	22
VBOH-32-G12	G1/2	45	60.5	42	15	27
VBOH-32-G34	G3/4	57.5	82	56.5	17	32

Ordering data

	Pneumatic connection		Standard nominal flow rate qnN [l/min]	Weight [g]	Part no.	Type
	1	2				
	M5	M5	236	8	1609969	VBOH-32-M5
	G1/8	G1/8	777	17	1558073	VBOH-32-G18
	G1/4	G1/4	1675	35	1302994	VBOH-32-G14
	G3/8	G3/8	2201	70	1482679	VBOH-32-G38
	G1/2	G1/2	3420	90	1587988	VBOH-32-G12
	G3/4	G3/4	7691	183	1629664	VBOH-32-G34